

3-Input DisplayPort HDMI & VGA Collaboration Switcher Scaler over HDBaseT™

Switch & Scale Three inputs
over CAT6 up to 230 feet (70m)

MPN: HDSC31D-4K

The KanexPro HDSC31D-4K is a three input Collaboration Switcher Scaler designed for sending DisplayPort, HDMI, or VGA - analog video and control up to 230 feet (70 meters) over a shielded CATx cable to an HDBaseT™ receiver supporting resolutions up to 4K/30Hz. The sender or receiver can be powered from either sides requiring only one power supply supporting POE (Power over Ethernet) and allowing you to switch between the sources and up-scale or downscale to desired video resolutions.

DisplayPort, HDMI, and VGA inputs are built on the Transmitter (Sender) with one HDBaseT output and serial control. This Collaboration Switcher supports video signals at resolutions up to 4K, including 1920x1200 and 1080p/60 Deep Color.

The HDSC31D-4K offers reliable switching and transmission of DisplayPort, HDMI, and analog video signals with HDCP 2.2 compliance. RS-232 and IR remote control facilitate integration



FEATURES

- 3-input Collaboration Switcher & Scaler w/HDBaseT
- Reliable switching with selectable output resolutions up to 4K@30Hz
- Transmission distance: Over CAT6 cable:
 - 70 meters: 1080p@60Hz@36bit; 3D1080p@30Hz@36bit;
 - 40 meters: 1080p @60Hz@48bit; 1080p @120Hz@24bit;
 - 3D, 1080p@60Hz@36bit; 4K x 2K@30Hz@24bit.
- VGA supports scaling resolutions up to 720p,1080p & 1600x1200@60Hz
- HDBaseT routing distance over STP CATx up to 230 feet (70m)
- Bi-directional POE support (Tx to Rx or Rx to Tx)
- Bi-directional IR control, front-panel & RS-232 pass thru
- Supports CEC & HDCP 2.2 compliant
- Locking power supplies
- Compact & slim design for flexible installation
- Includes mounting kits
- International power supply

APPLICATIONS

The low profile design and remote power (POE) capability enable discreet placement in lecterns, beneath tables in conference rooms, board rooms, or smart classrooms wherever needed to meet application requirements.

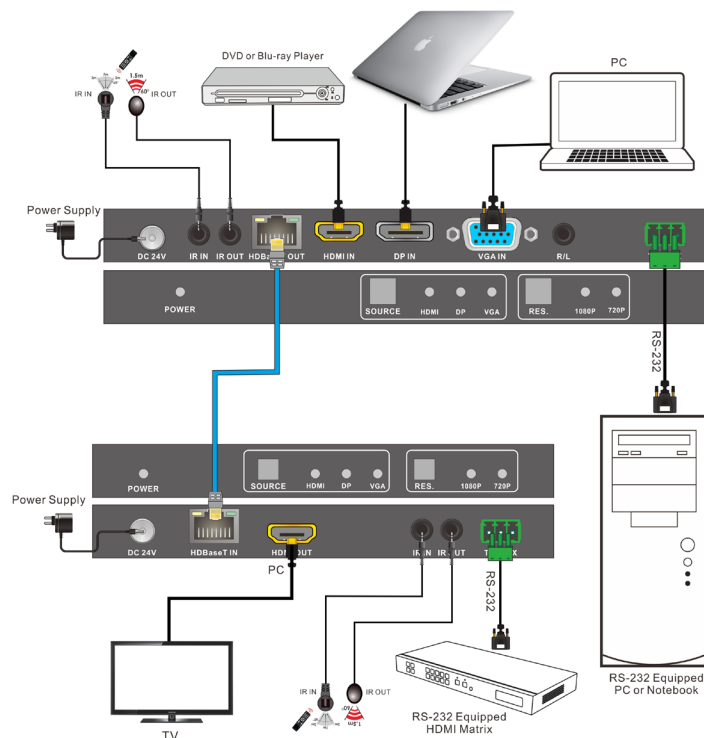

TECHNICAL SPECIFICATIONS

Input	1 HDMI1 VGA, 1 HDBaseT in	Output	1 HDMI, 1 HDBaseT out
InputConnector	1 female HDMI1 female VGA (15 pin)	OutputConnector	1 female HDMI
VideoSignal	DP/HDMI/VGA	VideoSignal	1 HDMI Video
IR Input		IR Output	
Input	1 IR IN	Output	1 IR OUT
InputConnector	3.5mm mini jack	OutputConnector	3.5mm mini jack
Video General			
Resolutionrange	HDMI: up to 4K/30Hz DisplayPort: 4K/30Hz, 1920x1200 & 2560x1600 VGA: 1024x768, 1280x720 1280x800, 1600x1200 & 1920x1080	Bandwidth	HDMI: 10.2 Gbps
MaximumPixel Clock	165MHz	Output	75 Ohms
Gain	0dB	Input/OutputLevel	0.5V~2.0Vp-p
HDMI, DisplayPort & HDCP Standards	Compliant with DVI & HDMI 1.4 standards, HDCP 2.2, Compliant to the VESA DisplayPort Standard, Version 1.1a, for both 1.62Gbps and 2.7Gbps. Support resolutions up to 4K x 2K@30Hz.		
Audio Input		Audio output	
Input	HDMI / DP audio	Output	via HDMI
Input Connector	HDMI, DP	OutputConnector	HDMI
InputImpedance	> 10 Kilo ohms	OutputImpedance	50 Kilo ohms
Audio General			
FrequencyResponse	20Hz~20K Hz	StereoChannelSeparation	> 80dB @1KHz
CMRR	> 90dB @20Hz to 20K Hz Audio Format: HDMI embedded audio: PCM, Dolby DTS		
Control Parts			
Control /Remote	IR remote, buttons & RS232 - Phoenix connectors	PinConfiguration	2=TX, 3=RX, 5=GND
General			
Temperature	0~45 C	Humidity	10% ~ 90%
PowerSupply	AC 24V, 1A	PowerConsumption	< 10 Watts max
CaseDimension(s)	Tx: W75mm x D193mm x H17.5mm Rx: W75mm x D145mm x H17.5mm	ProductWeight	Tx: 380g Rx: 290g